

\$359,000 - Parcel 0137920024, Omaha

MLS® #21923878

\$359,000

Bedroom, Bathroom,
Land on 22 Acres

Land, Omaha, NE

Opportunities galore on this beautiful property. Great spot to build your dream home. Space to spread out all while being close to interstate access and in town amenities. This tree lined property is a must see!

Essential Information

| | |
|----------|-----------|
| MLS® # | 21923878 |
| Price | \$359,000 |
| Acres | 21.60 |
| Type | Land |
| Sub-Type | Other |
| Status | Active |

Community Information

| | |
|-------------|-------------------|
| Address | Parcel 0137920024 |
| Area | Douglas County |
| Subdivision | Land |
| City | Omaha |
| State | NE |
| Zip Code | 68142 |

Amenities

| | |
|-----------|----------|
| Utilities | Electric |
|-----------|----------|

Exterior

| | |
|-----------------|---------|
| Lot Description | Rolling |
|-----------------|---------|

School Information

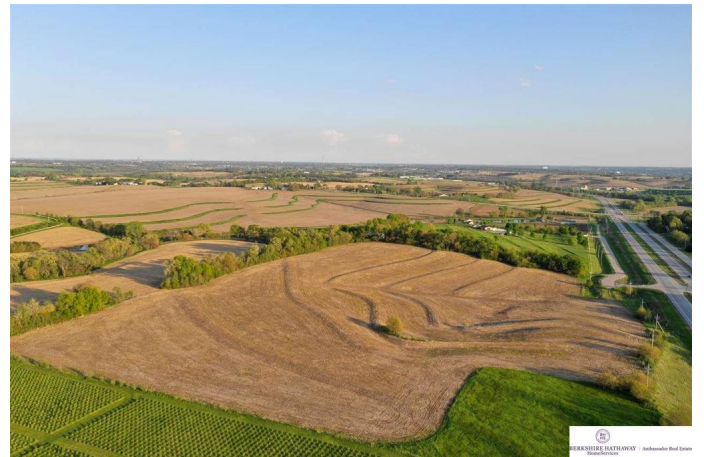

| | |
|------------|-----------|
| District | Omaha |
| Elementary | Boyd |
| Middle | Morton |
| High | Northwest |

Additional Information

| | |
|----------------|-------------------|
| Date Listed | October 8th, 2019 |
| Days on Market | 34 |

Listing Details

| | |
|----------------|-----------------------------|
| Listing Office | BHHS Ambassador Real Estate |
|----------------|-----------------------------|

Listing information is provided by Participants of the Midland MLS & Great Plains Regional Multiple Listing Service Inc. IDX program and is for consumers' personal, non-commercial use and may not be used for any purpose other than to identify prospective properties consumers may be interested in purchasing; The information is deemed reliable but is not guaranteed accurate. Copyright, 2019, Midland MLS & Great Plains REALTORS® Multiple Listing Service, Inc. Listing information last updated on November 12th, 2019 at 7:15am CST